

# SEZIONE 23

## A

## SISTEMAZIONI A VERDE

## B

PISTA

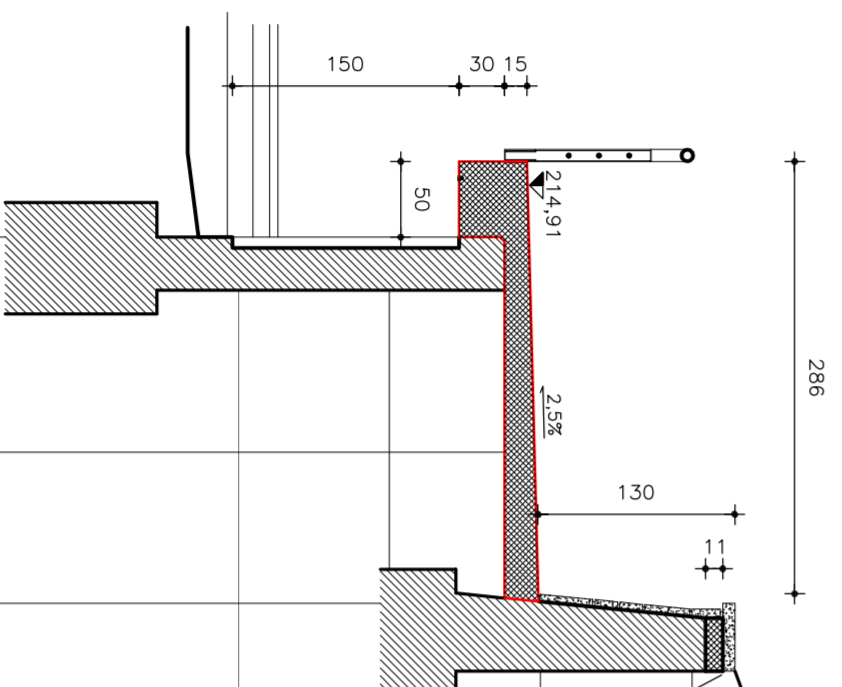

1520

747

579

15

846

704

210.00

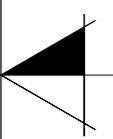

Q.T.	214.76	214.88	215.10	217.68	220.55	225.00
PAR.	1.42	1.00	4.32	4.06	6.50	
PRO.	0.00	1.42	2.42	6.74	10.80	17.30